

**SCHOTT MORITEX Reference**  
Data do not guarantee the performance of the product

# MML8-ST65DS / ST65S

## MML-Standard

Drawing No. A03978/A03979



レンズ形式	Lens Type	Fixed Magnification Object Side Telecentric Lens
光学倍率	Magnification	8.00
焦点距離 (mm)	Focal Length	8.43
有効Fno	Effective Fno	52.30
NA	Numerical Aperture	0.076
WD/OD (mm)	Working/Object Distance	64.9/66.9
O/I (mm)	Object to Image Distance	180.04
鏡筒長 (mm)	Mechanical Tube Length	97.60
レンズバック (mm)	Lens Back	59.52
被写界深度 (mm)	DOF @PCoC $\phi 0.04\text{mm}$	0.070
分解能 ( $\mu\text{m}$ )	Resolution @ $\lambda=550\text{nm}$	4.4
前側/後側主点位置 (mm)	Front/Rear Principal Position	-57.45/-16.29
入射/出射瞳位置 (mm)	Entrance/Exit Pupil Position	332.76/-8.03
入射/出射瞳径 (mm)	Entrance/Exit Pupil Diameter	61.11/1.29
テレセントリシティー (deg.)	Telecentricity	0.054(1/3Inch) 0.072(1/2Inch)
光学ディストーション (%)	Optical Distortion	-0.003(1/3Inch) -0.008(1/2Inch)
周辺光量比 (%)	Relative Illumination	100.02(1/3Inch) 100.05(1/2Inch)
質量 (g)	Weight	46.0/42.0
マウント	Mount	C Mount
イメージサークル径 (mm)	Image Circle	$\phi 8$
最大適合カメラ	Largest Compatible Camera	1/2 Inch

### MML8-ST65DS

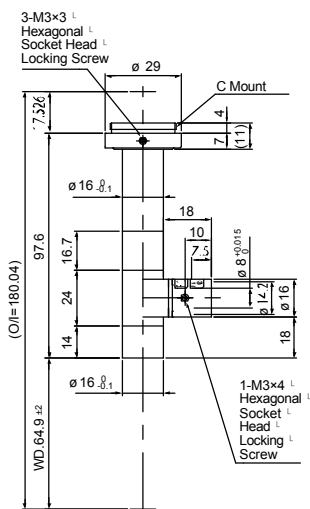

### MML8-ST65S

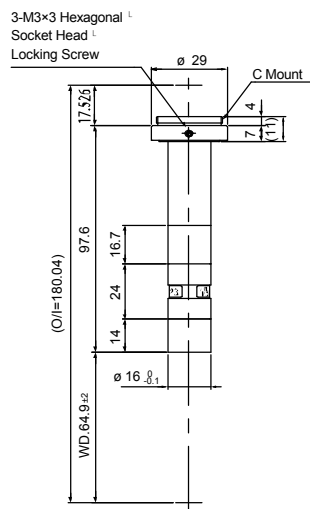

**SCHOTT MORITEX Reference**  
Data do not guarantee the performance of the product

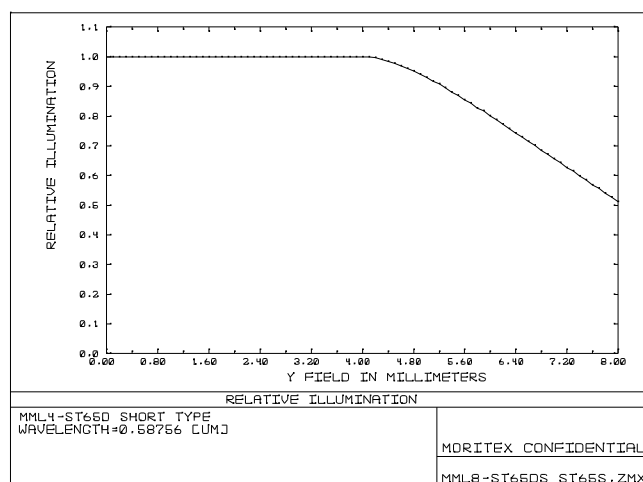
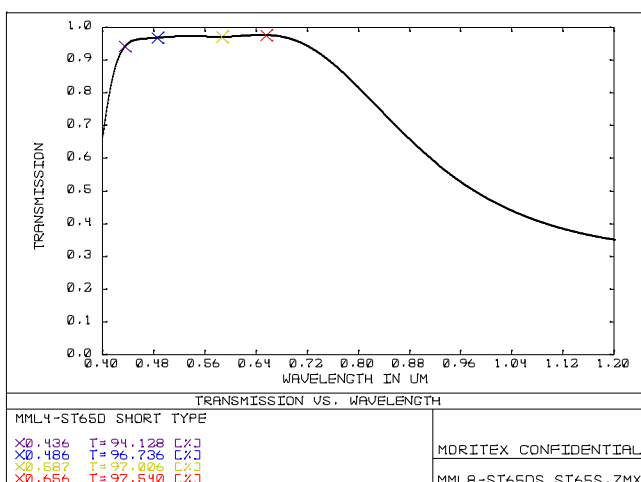
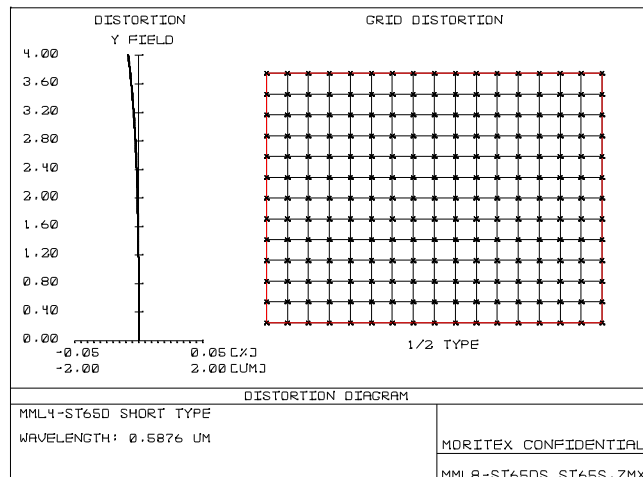
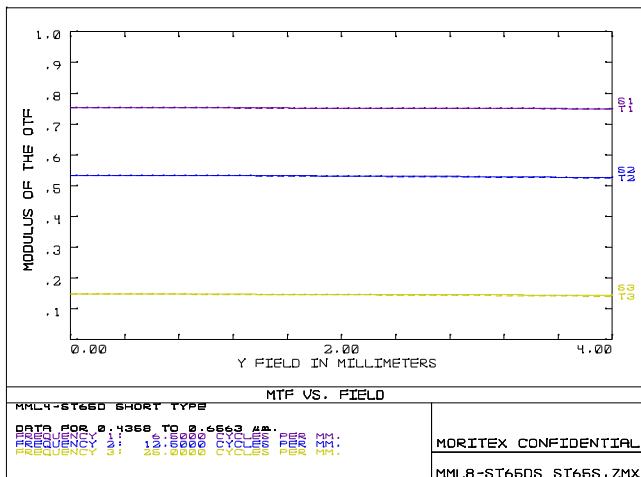

内容は、通知なしに随時変更されることがあります。

The content is subject to change at any time without notification.