

MML08-ST65D / ST65

SCHOTT MORITEX Reference
Data do not guarantee the performance of the product

MML-Standard

Drawing No. A03874/A03875



レンズ形式	Lens Type	Fixed Magnification Object Side Telecentric Lens
光学倍率	Magnification	0.80
焦点距離 (mm)	Focal Length	65.70
有効Fno	Effective Fno	14.90
NA	Numerical Aperture	0.027
WD/OD (mm)	Working/Object Distance	65.0/67.0
O/I (mm)	Object to Image Distance	172.30
鏡筒長 (mm)	Mechanical Tube Length	89.80
レンズバック (mm)	Lens Back	48.07
被写界深度 (mm)	DOF @PCoC $\phi 0.04\text{mm}$	1.860
分解能 (μm)	Resolution @ $\lambda=550\text{nm}$	12.4
前側/後側主点位置 (mm)	Front/Rear Principal Position	80.76/-70.04
入射/出射瞳位置 (mm)	Entrance/Exit Pupil Position	3,015.53/-5.81
入射/出射瞳径 (mm)	Entrance/Exit Pupil Diameter	165.35/3.62
テレセントリシティー (deg.)	Telecentricity	0.089(1/3Inch) 0.089(1/2Inch)
光学ディストーション (%)	Optical Distortion	0.003(1/3Inch) 0.003(1/2Inch)
周辺光量比 (%)	Relative Illumination	99.17(1/3Inch) 99.34(1/2Inch)
質量 (g)	Weight	49.0/44.0
マウント	Mount	C Mount
イメージサークル径 (mm)	Image Circle	$\phi 8$
最大適合カメラ	Largest Compatible Camera	1/2 Inch

MML08-ST65D

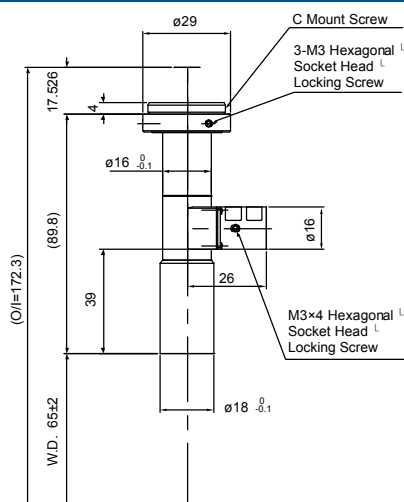

MML08-ST65

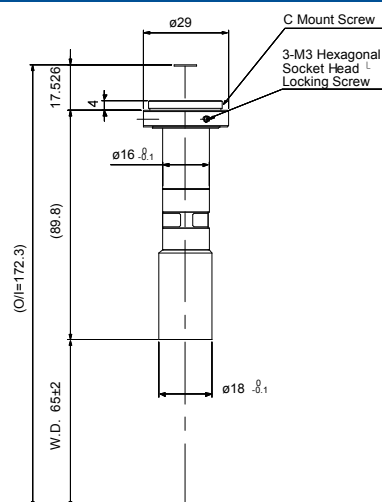

SCHOTT MORITEX Reference
Data do not guarantee the performance of the product

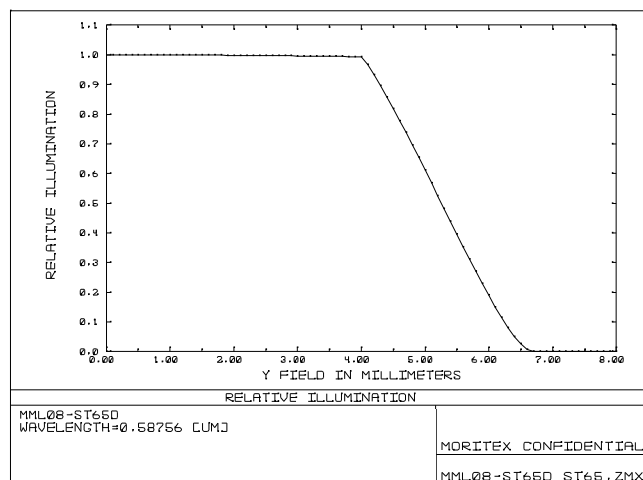
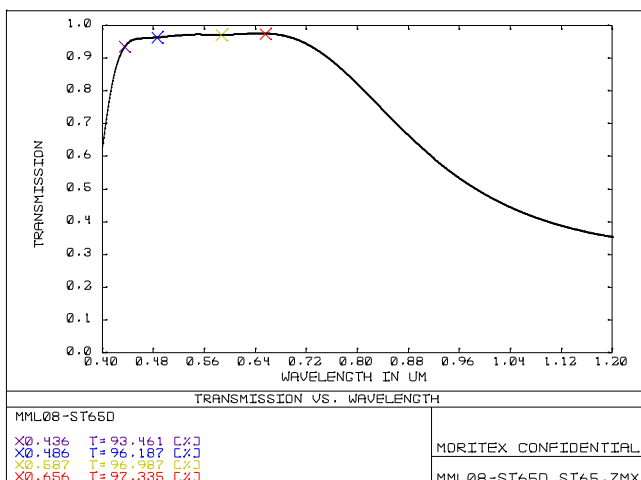
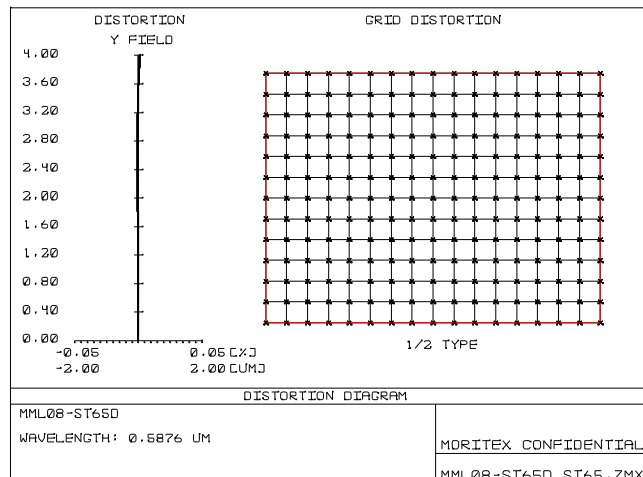
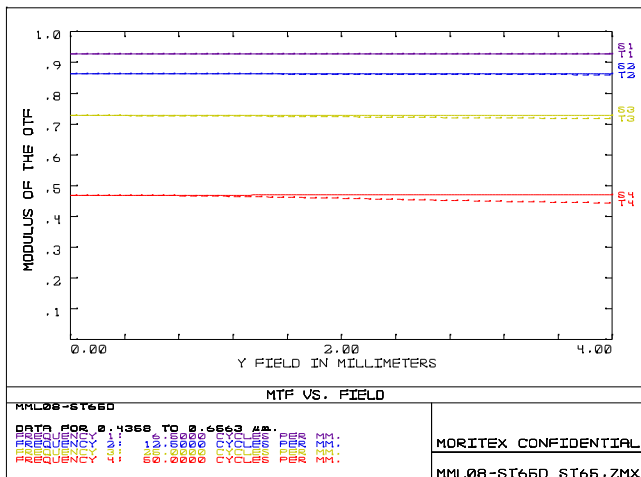

内容は、通知なしに随時変更されることがあります。

The content is subject to change at any time without notification.